

**OPTICAL REFLECTOR-  
Fibre Type**



**OPTICAL REFLECTOR  
- LC TYPE**



**OPTICAL REFLECTOR-  
SC Type**



# OPTICAL REFLECTOR

# Optical Reflector

## Applications

- Detection and maintenance of Passive Optical Network lines (applied to FTTx).



**OPTICAL REFLECTOR - LC TYPE**

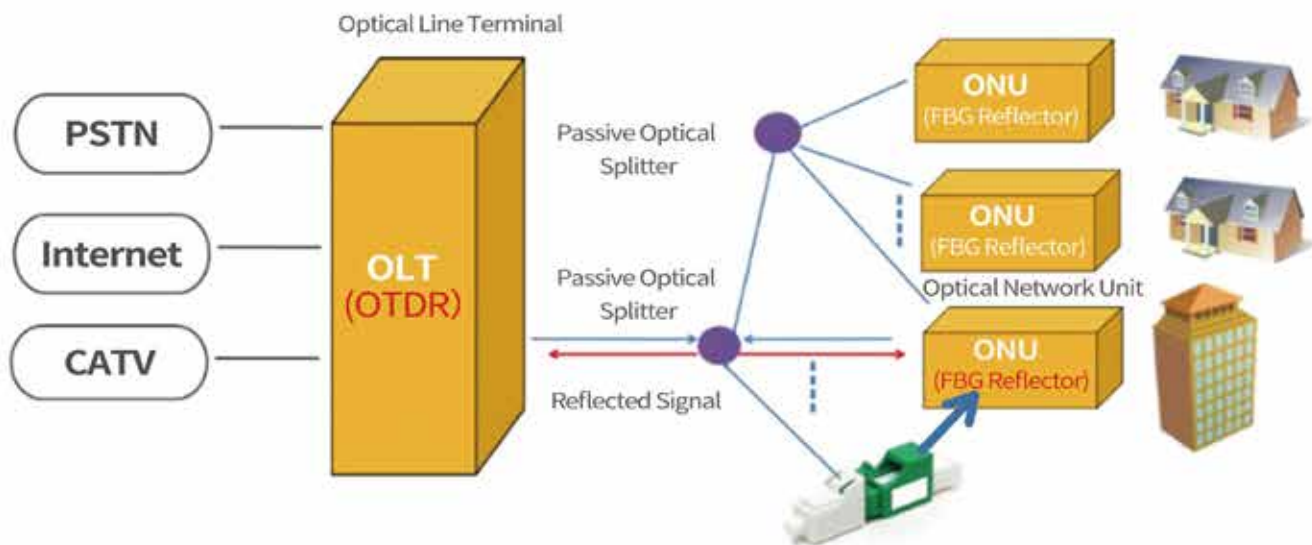

# OPTICAL REFLECTOR

## OPTICAL REFLECTOR

5-6

### SC TYPE



### SUSTUBE TYPE

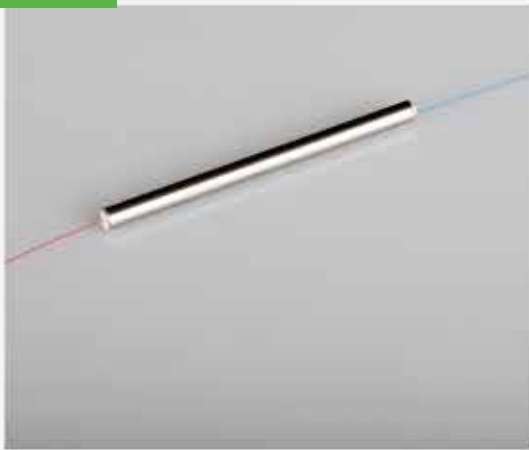

### LC TYPE



## SUS TUBE TYPE

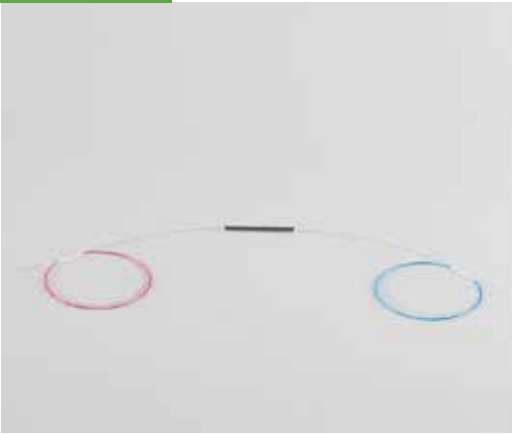

## SC TYPE



## LC TYPE



# OPTICAL REFLECTOR

### Overview

WCFO's fiber bragg grating (FBG) reflector is a low-cost specific band reflector mounted on the optical network unit (ONU) side. It is used to reflect light pulses (1650 +/- 5nm) from the OTDR on the fiber line terminal (OLT) side while the working bands of the passive optical network (PON) are transmitted normally.

### Features

- High stability and reliability
- Remote real-time detection
- Low insertion loss
- Easy connection for adapter structure
- Compliant with Telcordia GR-326-CORE, Telcordia GR-1221-CORE
- Compliant with RoHS

## Specifications

Parameters	Specifications
Pass band wavelength range (nm)	1260~1625
Reflect band wavelength range (nm)	1645~1655
Insertion loss @ 1260nm-1360&1460-1625nm (dB)	1.0
Insertion loss @ Reflect band (dB)	25
Return loss @ 1260nm-1360&1460-1610nm (dB)	32
Return loss @ 1610nm-1625nm (dB)	25
Return loss @ Reflect band (dB)	1.0
Ripple in Reflection Band (dB)	0.6
Polarization Dependent Loss(dB)	0.4
Temperature Dependent Loss (dB)	0.5
Operating Temperature (°C)	-25 ~ 65
Relative Humidity	5%~95%
Package Type	SC, LC Type
	SUS Tube Type

Note: 1625/1550/1490nm FBG reflector is also available

## Dimensions

### SC Type

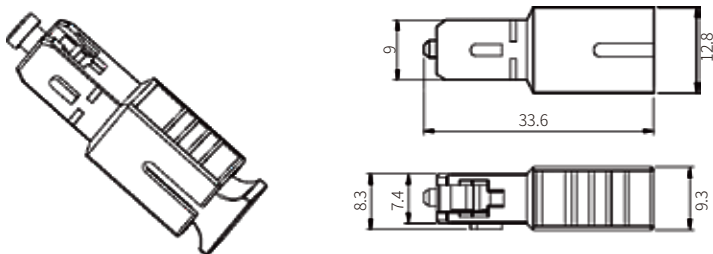

### LC Type

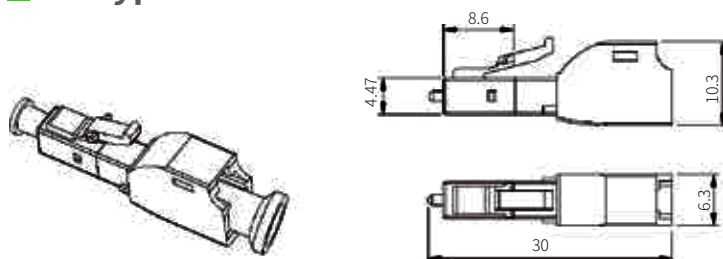

### SUS Tube Type

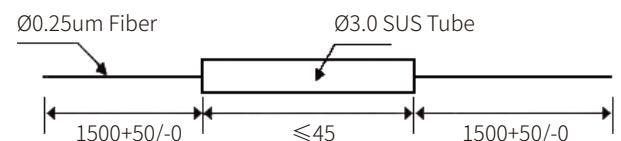



## ■ ABOUT US

WCFO is an industrial provider for optical fiber products and solutions of Telecom/Datacom. We provide the worldwide market with Easy/Green access optical fiber solutions, products and services.

## ■ CONTACT

- Tel:+852 3460 4735
- Fax:+852 3460 4736
- Email:sales@wcfo.com
- Address:Flat 11&12A,9/F Shatin Galleria No. 18-24  
ShanMei Street, Fotan, NT,Hong Kong
- <http://www.wcfo.com>